

# BOX HB 63 T4/T8 (A5:6) 0,55/0,09kW 4p 20°

## GENERAL DATA



### AXIAL IN SOUNDPROOF CABINET

#### MANUFACTURING FEATURES:

- BOX: Soundproof galvanised steel box with thermo-acoustic insulation, Bs1d0 fire class. Easy motor access and fan maintenance through removable panels.
- Inside fan: HB : Axial fan, circular reinforced frame from size 45 to 80. For larger sizes uses from 90 to 125 we use model HC . Motor-impeller assembly through a modular system. Variable pitch angle polyamide impeller reinforced with fibreglass. Polyester powder finishing coat.
- Squirrel cage asynchronous standard motor, IP-55 protection and rated class F insulation. Standard voltages 230V 50Hz for single phase motors, 230/400V 50Hz for three phase motors up to 4kW and 400/690V 50Hz for higher powers 1 speed and 400V for 2 speed motors.

#### APPLICATIONS

Designed for wall or duct installation, indoor or outdoor assembly, they are suitable for:

- Air renewal in buildings and industries.
- Smoke extraction
- Maximum working temperature: single phase 50°C, three phase 60°C.

#### UNDER REQUEST

- B form impeller (air flow from impeller to motor).
- 100% reversible impeller.
- Special voltages.

## PERFORMANCE CURVE

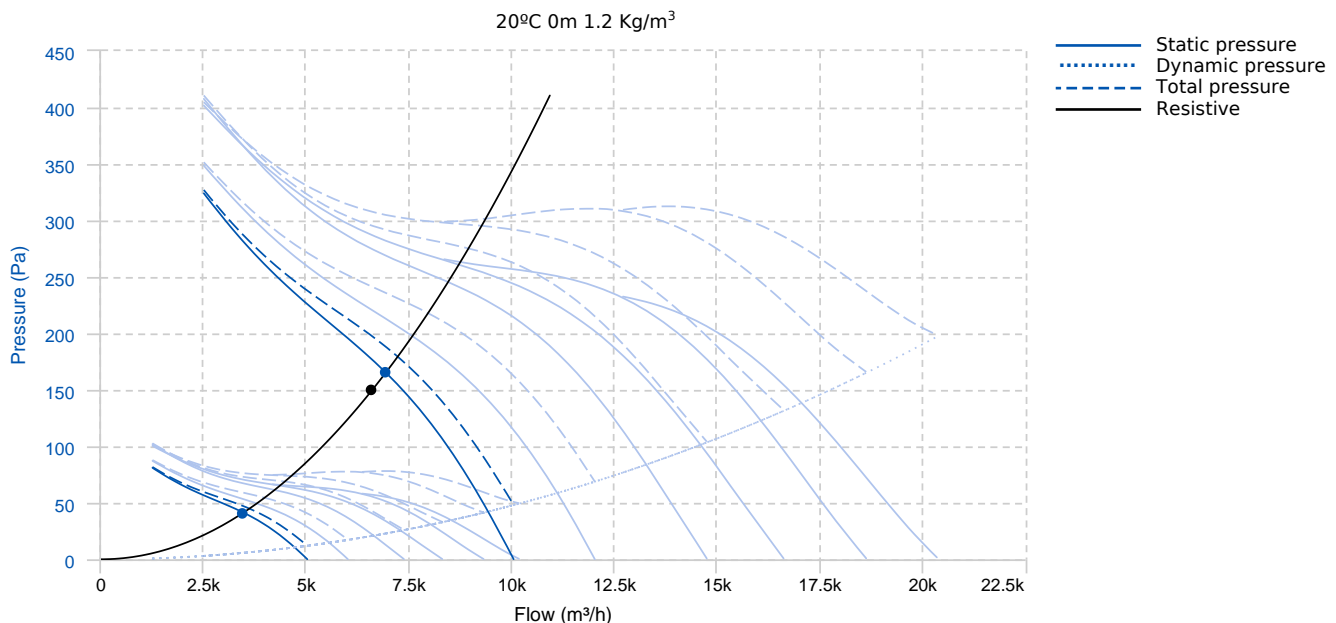

### Design point

Flow (m <sup>3</sup> /h)	6600	Pressure (Pa)	150
--------------------------	------	---------------	-----

## Service point

	4p/20°	710/20°		4p/20°	710/20°
Speed	4p	710	Pt (Pa)	188.16	47.04
Angle	20	20	Speed (m/s)	6.17	3.09
T.max (°C)	60	60	Security coefficient	1.22	9.72
Q (m³/h)	6928.34	3464.17	Mechanical total efficiency	81.24	81.24
Ps (Pa)	165.3	41.32	Pw.mec (kW)	0.45	0.06
Pd (Pa)	22.86	5.72	Precom (kW)	0,55/0,09	0,55/0,09

## TECHNICAL DATA

### Fan

Approx. weight	72.74 kg	Max. Flow	20350 m³/h
----------------	----------	-----------	------------

### Motor

Power	0,55/0,09 kW	RPM	1410/710	I max. (400V)	1,77/0,61 A	Size	80M
Approx. weight	9.3 kg	Efficiency (%)	70/53 %	FP	0,70/0,49		

## ACOUSTIC DATA (INLET)

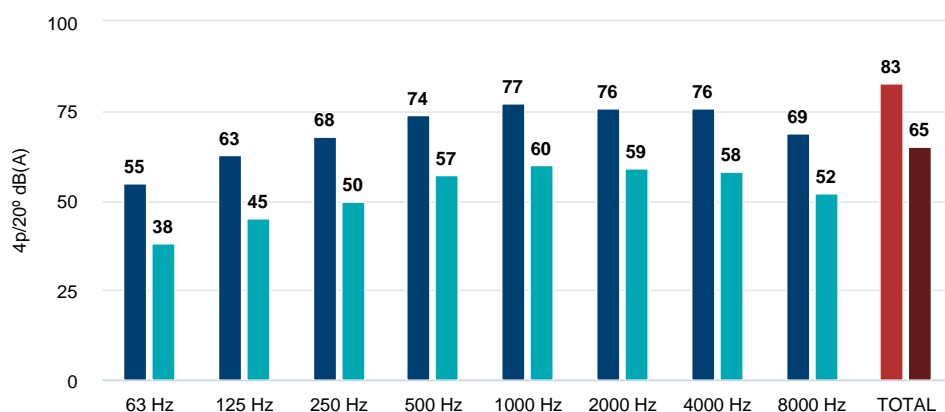

### Sound power

	4p/20°	710/20°
63 Hz	55	39
125 Hz	63	47
250 Hz	68	52
500 Hz	74	59
1000 Hz	77	62
2000 Hz	76	60
4000 Hz	76	60
8000 Hz	69	54
TOTAL	83	67

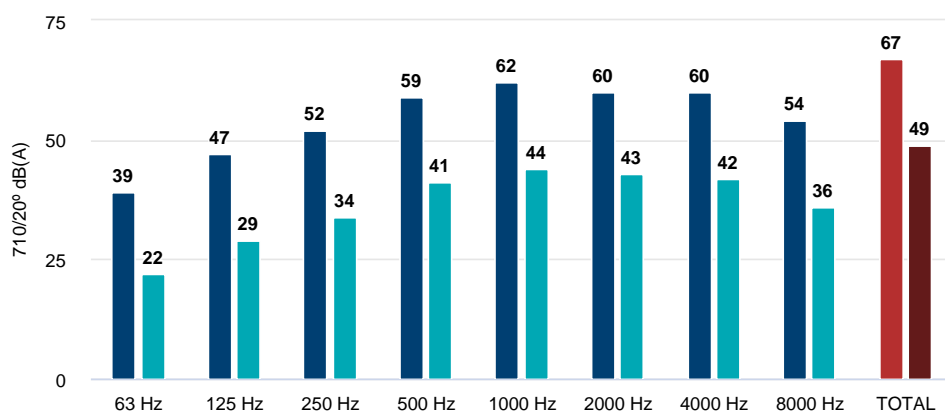

### Sound pressure 3m Q=2

	4p/20°	710/20°
63 Hz	38	22
125 Hz	45	29
250 Hz	50	34
500 Hz	57	41
1000 Hz	60	44
2000 Hz	59	43
4000 Hz	58	42
8000 Hz	52	36
TOTAL	65	49

## DIMENSIONS

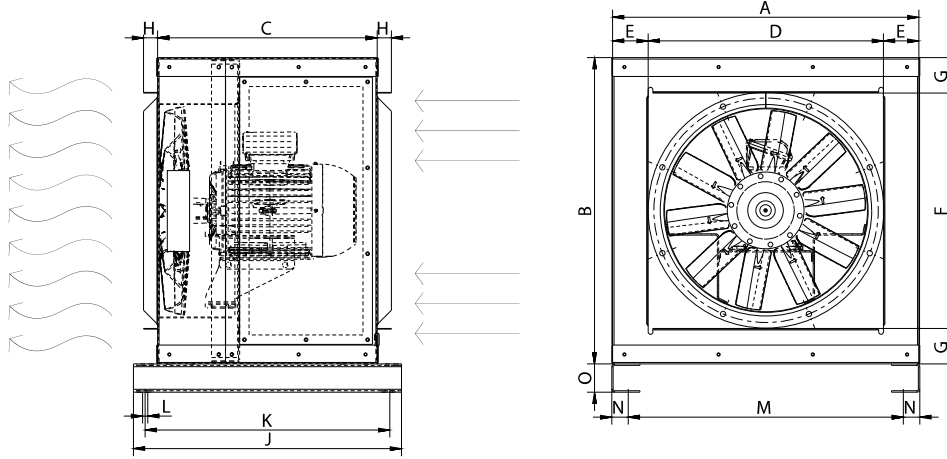

### Dimensions (mm)

A	781.5	B	781.5	C	542	D	630	E	76
F	630	G	76	H	30	J	665	K	610
L	11	M	715	N	35	O	60		

## WIRING DIAGRAM

### 400V DAHLANDER (Y,YY)

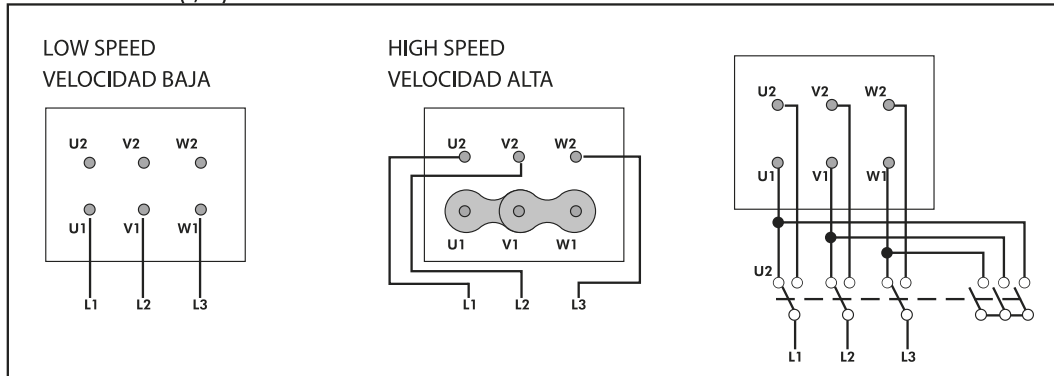

**ACCESSORIES**



**ANTI-VIBRATION JOINT**  
**JE 45**  
**REF: 300719201**



**SAFETY SWITCH**  
**INT (GENERIC)**



**ANTI-VIBRATION RUBBER BLOCK**  
**AVR (GENERIC)**



**ANTI-VIBRATION SPRING BLOCK**  
**AVS (GENERIC)**



**OUTDOOR FLANGE WITH BIRD GUARD FOR BOX**  
**HB**  
**VISERA BOX HB 56-63**  
**REF: VISB0640150**

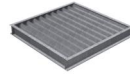

**DEPRESSION DUMPER (HORIZONTAL or**  
**VERTICAL PLACEMENT)**  
**CMP-HUT 630x630**  
**REF: CMPHUT6363**